

fixed-mounted circuit breaker 4-pole, size III, IEC In=5000A to 690V, AC50/60Hz Icu=100kA at 500V rear connection vertical Overcurrent release ETU 25 LSI protection adjustable 0.4-1 in Motorized/manual operating mechanism with spring charging motor AC 50/60 Hz 208-240 V or 220-250 V DC Activation AC 50/60 Hz 230 V, 220 V DC With 1st auxiliary release Shunt release "F", F1 50/60 Hz 230 V AC/220 V DC, 100% on-load factor without 2nd auxiliary release 2NO+2NC

Model	
product brand name	SENTRON
product designation	ACB
design of the product	IEC 60947-2
design of the actuating element	Pushbutton
type of the driving mechanism	Manual/motorized operating mechanism with mechanical and electrical closing
type of the driving mechanism / motor drive	Yes
design of the overcurrent release	ETU25B
General technical data	
number of poles	4
size of the circuit-breaker	3
utilization category	B
circuit-breaker / Design	3WL1
Voltage	
Rated insulation voltage Ui	1 000 V
insulation voltage / rated value	1 000 V
operating voltage	
• at AC / at 50/60 Hz / rated value	690 V
Protection class	
protection class IP	IP20
protection class IP / on the front	IP20
protection function of the overcurrent release	LSI
Dissipation	
power loss [W]	
• for rated value of the current / at AC / in hot operating state / per pole	210 W
• maximum	630 W
Current	
operational current	
• at 40 °C / rated value	5 000 A
• at 45 °C / rated value	5 000 A
• at 50 °C / rated value	5 000 A
• at 55 °C / rated value	5 000 A
• at 60 °C / rated value	5 000 A
• at 65 °C / rated value	5 000 A
• at 70 °C / rated value	5 000 A
continuous current / rated value / maximum	5 000 A
continuous current / rated value	5 000 A
adjustable current response value current	
• of instantaneous short-circuit trip unit / minimum	50 000 A
• of instantaneous short-circuit trip unit / maximum	50 000 A
Main circuit	
operating frequency	
• 1 / rated value	50 Hz
• 2 / rated value	60 Hz
Auxiliary circuit	
number of NC contacts / for auxiliary contacts	2

number of NO contacts / for auxiliary contacts	2	
<b>Suitability</b>		
suitability for use	Plant / motor protection	
<b>Product details</b>		
product component		
• trip indicator	Yes	
• voltage trigger	Yes	
• undervoltage release	No	
design of the auxiliary switch	2 NO + 2 NC	
product extension / optional / motor drive	No	
<b>Product function</b>		
product function		
• grounding protection	No	
• phase failure detection	Yes	
<b>Display and operation</b>		
display version	without display	
<b>Short circuit</b>		
operating short-circuit current breaking capacity (Ics)		
• at 415 V / rated value	100 kA	
• at 500 V / rated value	100 kA	
• at 690 V / rated value	85 kA	
maximum short-circuit current breaking capacity (Icu)		
• at 415 V / rated value	100 kA	
• at 500 V / rated value	100 kA	
• at 690 V / rated value	85 kA	
<b>Connections</b>		
arrangement of electrical connectors / for main current circuit	Main terminal on the rear vertical	
type of electrical connection / for main current circuit	busbar connection	
<b>Mechanical Design</b>		
height	439 mm	
width	914 mm	
depth	419 mm	
fastening method	fixed mounting	
<b>Environmental conditions</b>		
ambient temperature / during operation		
• minimum	-20 °C	
• maximum	70 °C	
ambient temperature / during storage		
• minimum	-40 °C	
• maximum	70 °C	
<b>General Product Approval</b>	<b>EMC</b>	<b>Declaration of Conformity</b>



[Confirmation](#)



**Test Certificates**

**Marine / Shipping**

[Special Test Certificate](#)

[Type Test Certificates/Test Report](#)

[Miscellaneous](#)



**Marine / Shipping**

other



other Dangerous Good

[Miscellaneous](#)

[Transport Information](#)

Further information

Industry Mall (Online ordering system)

<https://mall.industry.siemens.com/mall/en/en/Catalog/product?mfb=3WL1350-4CB41-4GA2>

Service&Support (Manuals, Certificates, Characteristics, FAQs,...)

<https://support.industry.siemens.com/cs/ww/en/ps/3WL1350-4CB41-4GA2>

Image database (product images, 2D dimension drawings, 3D models, device circuit diagrams, ...)

[http://www.automation.siemens.com/bilddb/cax\\_en.aspx?mfb=3WL1350-4CB41-4GA2](http://www.automation.siemens.com/bilddb/cax_en.aspx?mfb=3WL1350-4CB41-4GA2)

CAX-Online-Generator

<http://www.siemens.com/cax>

Tender specifications

<http://www.siemens.com/specifications>

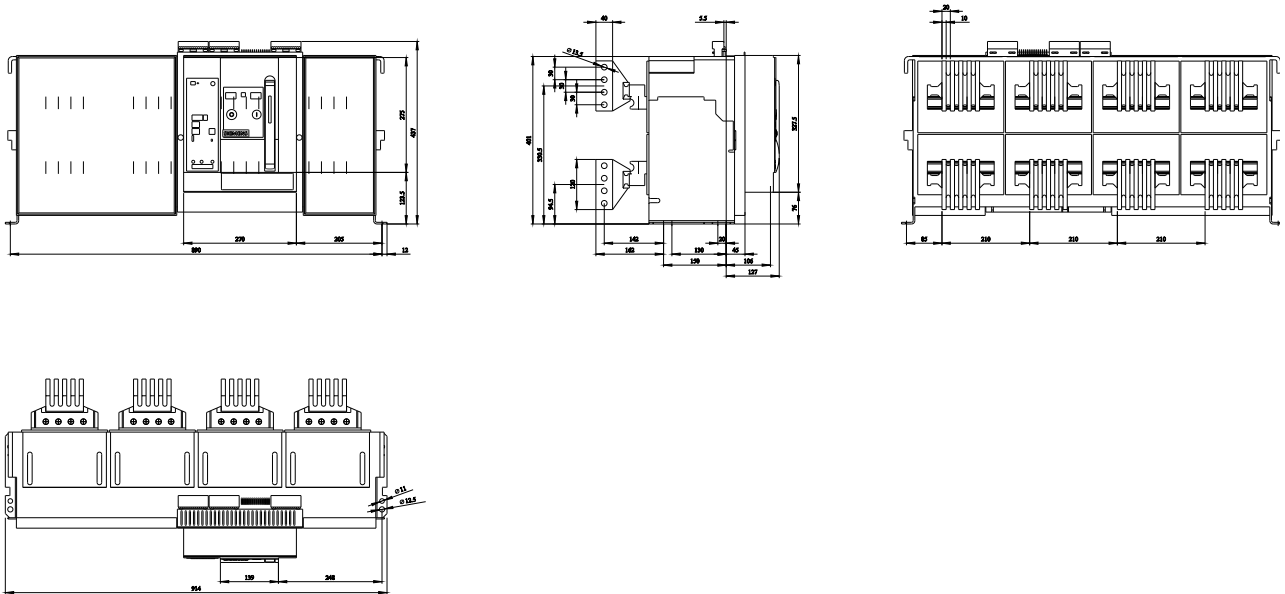

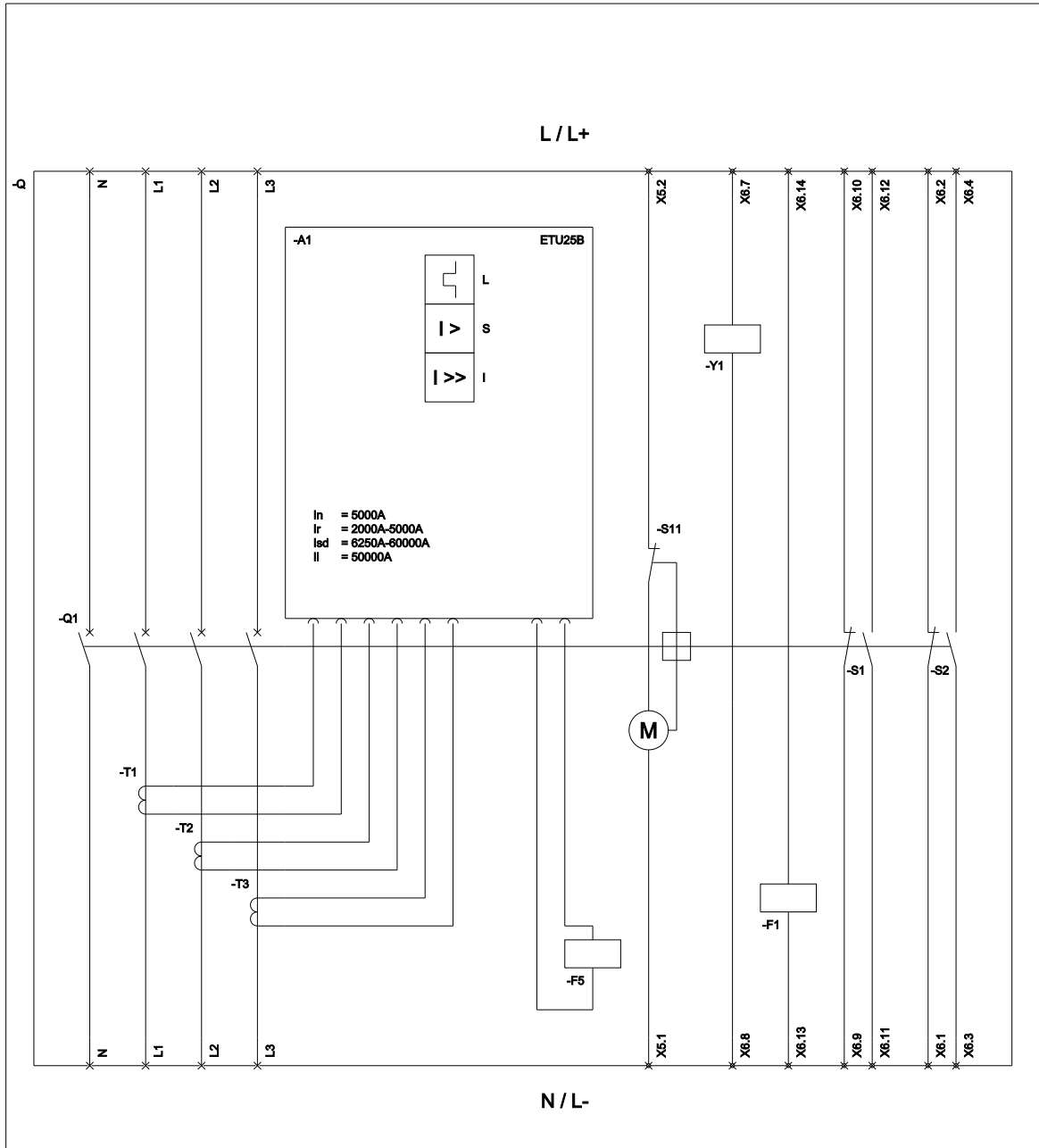

L (Long Time Delay / Überlastschutz); S (Short Time Delay / Kurzschlusschutz, kurzzeitzögernd); I (Instantaneous / Kurzschlusschutz, unverzögert);  
 S11 (Internal motor shutdown switch, if spring is tensioned / Interner Motorabstellschalter, wenn Feder gespannt); F1 (1st auxiliary release / Erster Hilfsauslöser);  
 F5 (Maglatch for trip unit / Auslösemagnet); S1 - S8 (Auxiliary switch / Hilfschalter); Y1 (Closing coil / Einschaltmagnet);

last modified:

3/8/2020

