

DS CODE:
700702

LS Simple™ Cabling Solution

Fiber Optic Connector & Adaptor

➤ Description

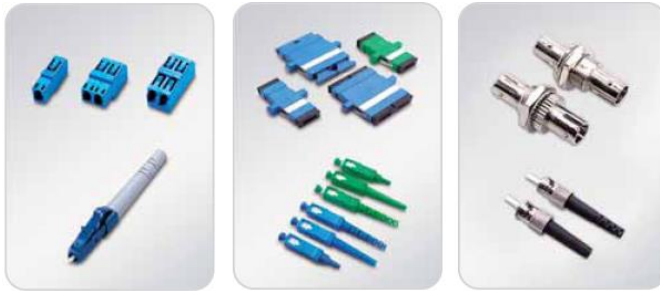

- Easy installation in the field without adhesive & polishing
- Performance exceeds ANSI/TIA-568-A
- High-performance interconnections offer very low Insertion Loss
- Telcordia GR-1081-CORE
- Fiber optic Connector & Adaptor LC, SC, FC, ST etc.
- Adaptors are supplied with dust caps
- Environmental stable

➤ Technical Details

Electrical / Mechanical Characteristics	
Insertion Loss	≤0.3dB
Durability	Max. 0.2dB increase after 500-Cycle
Retention Force	200~600g
Temperature	-20°C ~ 70°C (-4°F ~ 158°F)
Materials	
Ferrule	: Ceramic (Zirconia) for Single/Multi mode
Sleeve	: Ceramic (Zirconia) for Single/Multi mode
Housing	: High Impact Flame Retardant Plastic, UL 94V-0~2 Rated

➤ Part Numbers

Items	Description	Part Numbers
Adaptor	Fiber Adaptor LC type (without Flange)	LS-FA-LC-xx-C-y-zz-WO
	Fiber Adaptor LC type (with Flange)	LS-FA-LC-xx-C-y-zz-W
	Fiber Adaptor SC type (without Flange)	LS-FA-SC-xx-C-y-zz-WO
	Fiber Adaptor SC type (with Flange)	LS-FA-SC-xx-C-y-zz-W
	Fiber Adaptor ST type	LS-FA-ST-xx-C-y
Connector	Fiber Connector LC type	LS-FC-LC/PC-xx-y-zz
	Fiber Connector SC type	LS-FC-SC/PC-xx-y-zz
	Fiber Connector ST type	LS-FC-ST/PC-xx-y-zz

* xx denotes SM (Single Mode) or MM (Multi Mode)

* y denotes 1 or 2 Core

* zz denotes Color : BL (Blue)-SM/PC, BG (Beige)-MM/PC, GN (Green)-SM/APC

DS CODE:
700702

LS Simple™ Cabling Solution

Door Type Fiber Adaptor – LC Type

➤ Description

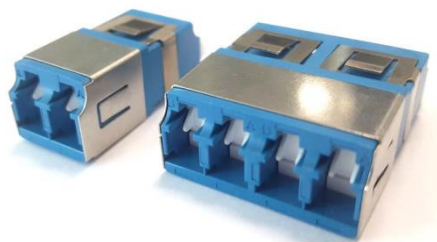

- Prevent damage of dust by Automatic Shutter
- Easy installation in the field without adhesive & polishing
- Performance exceeds ANSI/TIA-568-A
- High-performance interconnections offer very low Insertion Loss
- Telcordia GR-1081-CORE
- Adaptors are supplied with dust caps
- Environmental stable

➤ Technical Details

Electrical / Mechanical Characteristics	
Insertion Loss	≤0.3dB
Durability	Max. 0.2dB increase after 500-Cycle
Retention Force	200~600g
Temperature	-20°C ~ 70°C (-4°F ~ 158°F)
Materials	
Ferrule	: Ceramic (Zirconia) for Single/Multi mode
Sleeve	: Ceramic (Zirconia) for Single/Multi mode
Housing	: High Impact Flame Retardant Plastic, UL 94V-0~2 Rated

➤ Part Numbers

Items	Description	Part Numbers
Door Type Adaptor	Door Type Fiber Adaptor LC type (without Flange)	LS-FA-LC-xx-C-y-zz-WOD

* xx denotes SM (Single Mode) or MM (Multi Mode)

* y denotes 2 or 4 Core

* zz denotes Color : BL (Blue)-SM/PC, BG (Beige)-MM/PC, AQ (Aqua)-OM3, HV (Header Violet)-OM4, GN (Green)-SM/APC

DS CODE:
700702

LS Simple™ Cabling Solution

Door Type Fiber Adaptor – LC Type

➤ Drawing

Dupelx

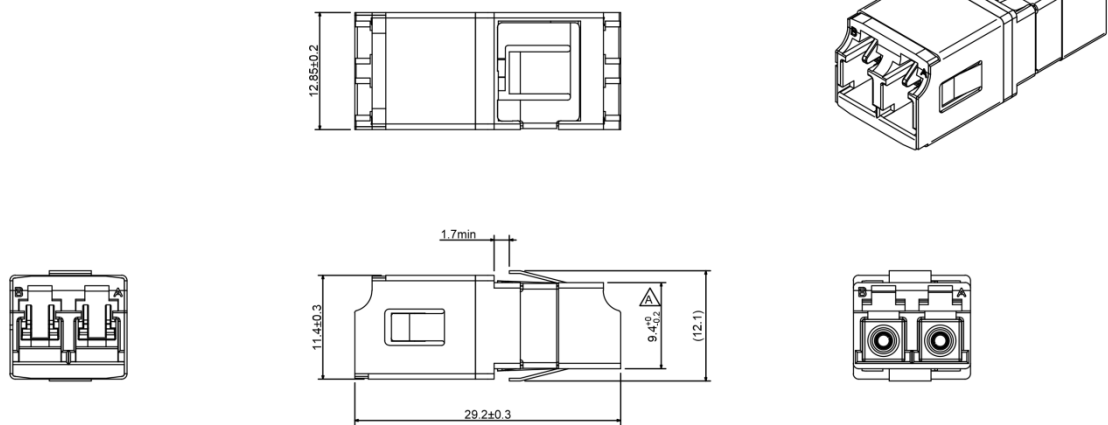

Quad

