

DS CODE:
300102

LS Simple™ Cabling Solution

LS-PP-UC5E-24P-EC

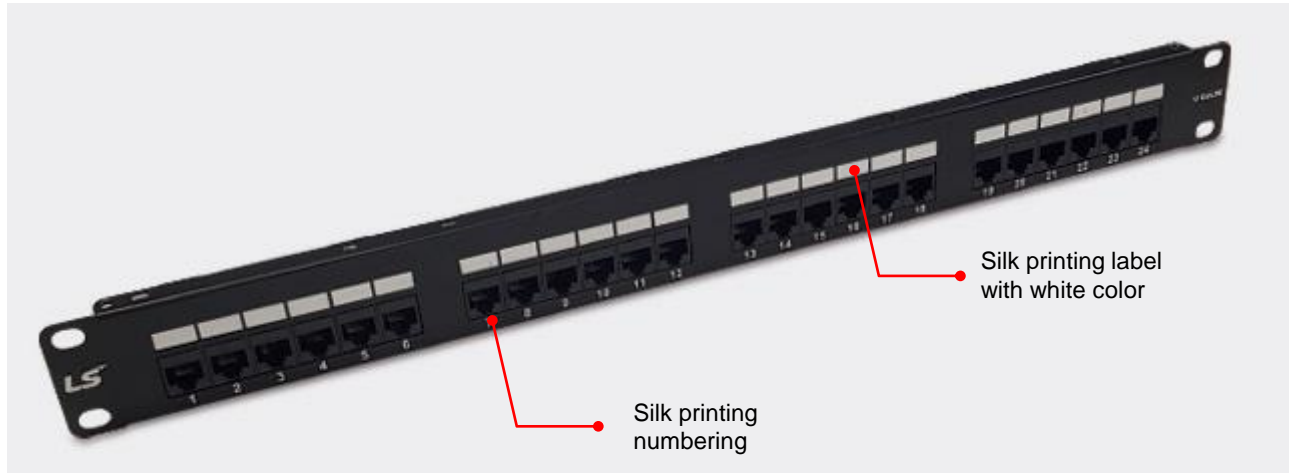

➤ Description

LS Simple™ PCB type 1Unit 24-port unshielded patch panel comes complete with accessories & full instructions. It fully complies with the ANSI/TIA-568.D-2(Category 5e), RJ-45 of 47 CFR part 68 and ISO/IEC 11801 standards. The panel modules are individually terminated using IDC giving assurance of wire connection and using punching down tool (LS-TOOL-MJ or LS-STOOL).

➤ Application

- Horizontal Distribution & Backbone Cabling
- 4/16 Mbps Token Ring (IEEE 802.5)
- 10/100/1000 BASE-T (IEEE 802.3)
- 155 Mbps ATM
- 100Mbps TP-PMD
- ISDN, ADSL
- RoHS2 compliant
- ATM LAN 1.2G

➤ Part Numbers

Description	Dimension (H x W xD mm)	Part Numbers	Compatible Items
24-Port Category 5e Unshielded Patch Panel	44x482.5x30.9	LS-PP-UC5E-24P-EC	19" standard rack 1unit Tool: LS-TOOL MJ or LS-STOOL

**DS CODE:
300102**

LS Simple™ Cabling Solution

LS-PP-UC5E-24P-EC

➤ Technical Details

Item	Unit	Information
FEATURE		
Approvals		UL, KC
Category		ANSI/TIA-568.D-2 (Category 5e)
Meet		CFR 47 Parts 68
Wiring scheme		T568A/T568B
ELECTRICAL		
Current Rating	Amps	1.5
Insulation Resistance	Mega-ohm	> 500
Contact Resistance	milli-ohm	< 20
DC Resistance	milli-ohm	< 200
Voltage proof	V _{DC}	< 1000
MECHANICAL		
Insertion Life	Mating cycles	750 mating cycles
Pull Force	lbs(N)	20lbs (89N)
Temperature	°C	-10°C ~ 60°C
Humidity	%	10% ~ 90% RH
IDC accept	AWG	22~24 (Solid wire), 200 termination cycles
PHYSICAL		
Panel		SPCC
Plastic frame		ABS, UL94V-0
Jack contacts		Phosphor bronze, 50μ-inch gold coating
IDC Plastic		PC, UL94V-0
IDC Terminals		Phosphor bronze, tin over nickel undercoat

DS CODE:
300102

LS Simple™ Cabling Solution

LS-PP-UC5E-24P-EC

Drawing

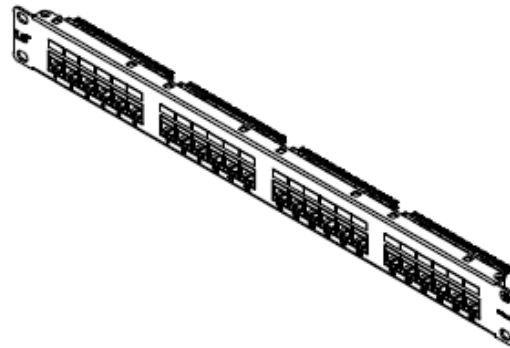
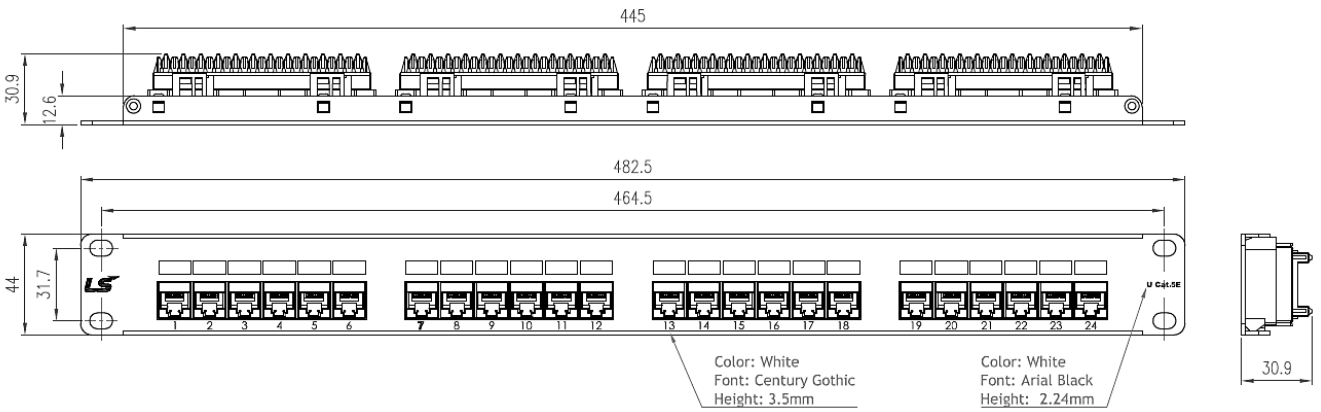

DS CODE:
300102

LS Simple™ Cabling Solution

LS-PP-UC5E-24P-EC

➤ Instruction

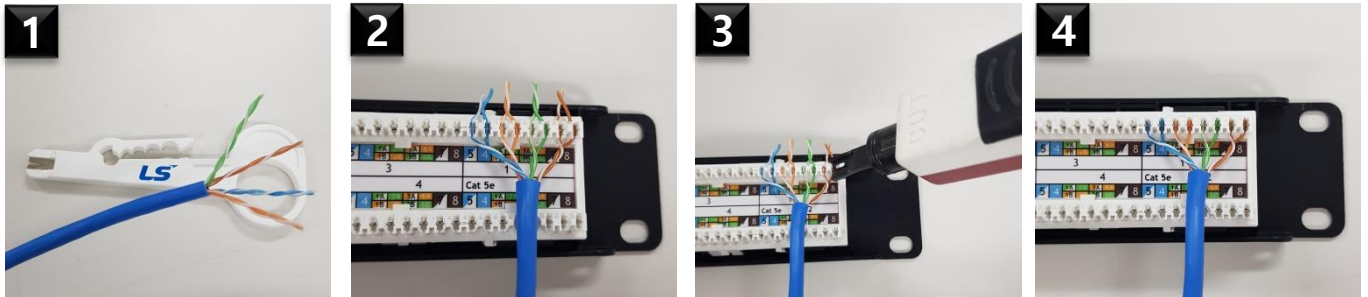

1. Strip the sheath about 40mm
2. Arrange the insulation wire to IDC slots according to T568A/B wiring scheme

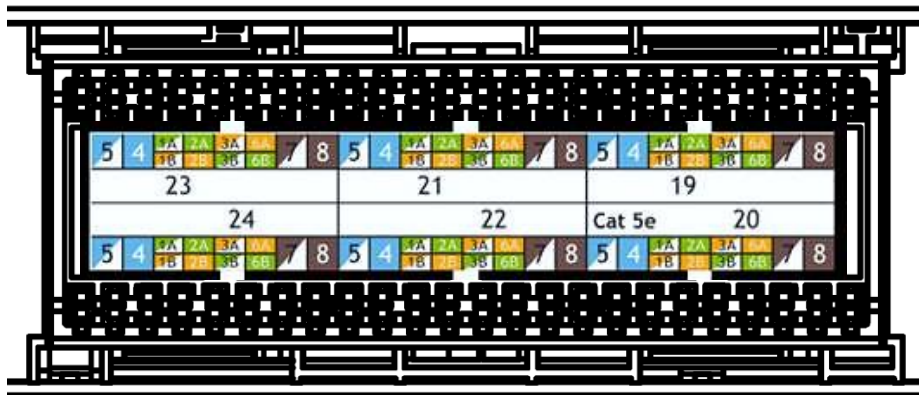

TIA568A	White/Blue	Blue	White/Green	Green	White/Orange	Orange	White/Brown	Brown
TIA568B	White/Blue	Blue	White/Orange	Orange	White/Green	Green	White/Brown	Brown

3. Terminate the cable and cut the insulation wire by 1-pin IDC punch tool
4. Check the wiring scheme and the cable termination

* Caution

- Do not make untwisted length more than 12.7mm for performance such as cross talk
- Always use 1-pin tools and do not use multi-pin tools such as 8-pin type
- Use only 1-pin tool or nipper for cutting excess wires of IDC blocks (knife X)
- Make sure that the radius of curvature is about 24mm when organizing the cable